



WINNIPEG CONVENTION CENTRE

375 YORK AVENUE, WINNIPEG, MANITOBA, CANADA R3C 3J3

PHONE: (204) 956-1720 FAX: (204) 943-0310

TOLLFREE: 1-800-565-7776 EMAIL: info@wcc.mb.ca

www.wcc.mb.ca

GROUND FLOOR PLAN

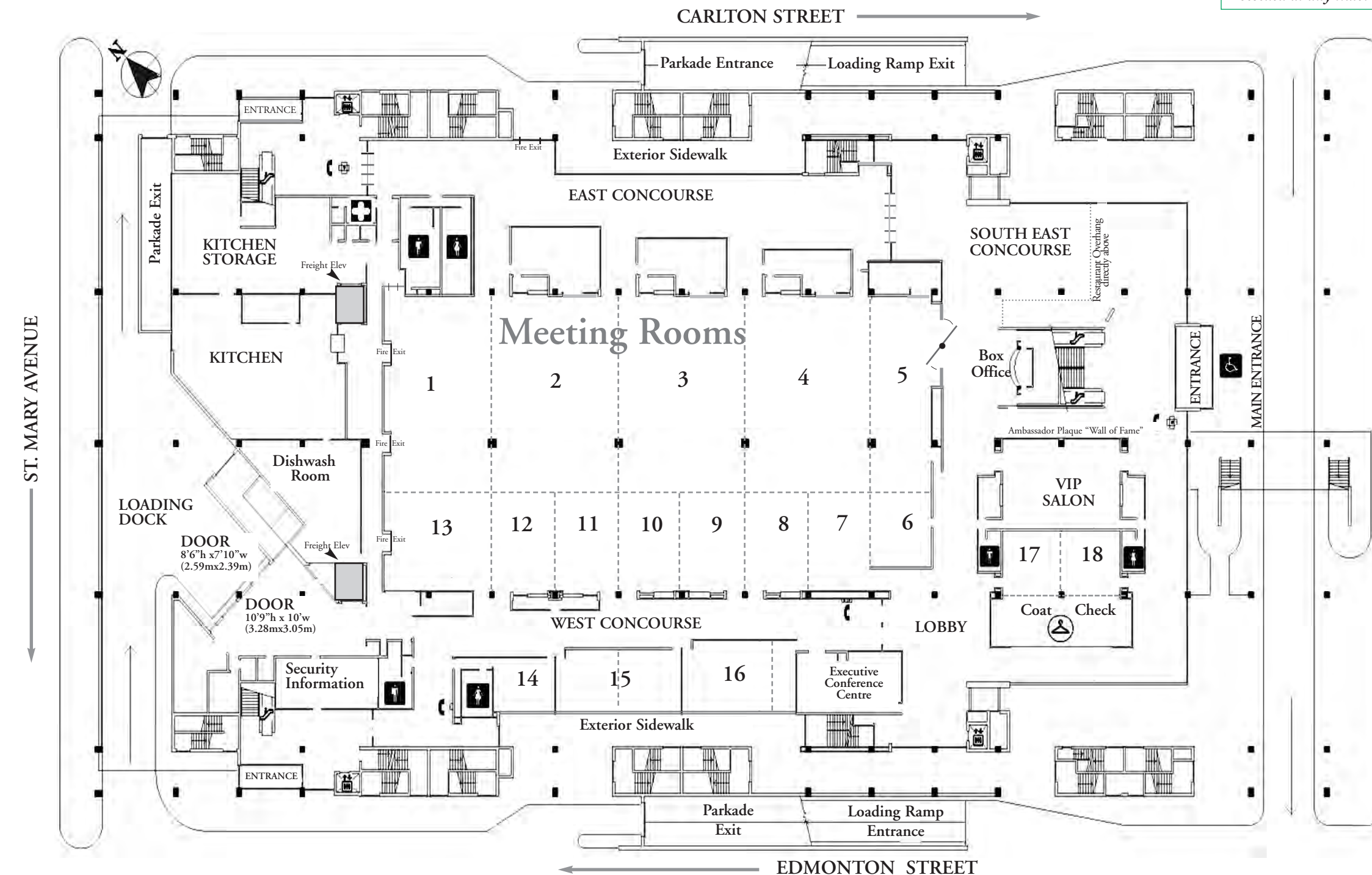

■ indicates load-bearing pillar
 ----- indicates movable wall panels

NOTE:
 Fire Exits must not be blocked at any time.

	BANQUET & MEETING ROOMS	SIZE LxWxH ft (M)	SQUARE AREA ft (M)	THEATRE	CLASSROOM	RECEPTION	BANQUET
MR 1	67x41x14 (20.42x12.50x4.27)	2750 (255.25)	290	145	290	195	
MR 2	67x50x14 (20.42x15.24x4.27)	3350 (311.20)	400	200	400	240	
MR 3	67x50x14 (20.42x15.24x4.27)	3350 (311.20)	400	200	400	240	
MR 4	67x50x14 (20.42x15.24x4.27)	3350 (311.20)	400	200	400	240	
MR 5	67x24x14 (20.42x7.32x4.27)	1610 (149.47)	175	85	175	115	
MR 6	24x25x14 (7.32x7.62x4.27)	600 (55.78)	60	30	60	40	
MR 7	33x25x14 (10.06x7.62x4.27)	825 (76.66)	95	50	95	60	
MR 8	33x25x14 (10.06x7.62x4.27)	825 (76.66)	95	50	95	60	
MR 9	33x25x14 (10.06x7.62x4.27)	825 (76.66)	95	50	95	60	
MR 10	33x25x14 (10.06x7.62x4.27)	825 (76.66)	95	50	95	60	
MR 11	33x25x14 (10.06x7.62x4.27)	825 (76.66)	95	50	95	60	
MR 12	33x25x14 (10.06x7.62x4.27)	825 (76.66)	95	50	95	60	
MR 13	33x41x14 (10.06x12.50x4.27)	1350 (125.75)	150	75	150	90	
MR 14	24x18x12 (7.32x5.49x3.66)	430 (40.19)	50	25	50	25	
MR 15	50x21x12 (15.24x6.40x3.66)	1050 (97.54)	100	55	100	70	
MR 16	45x24x12 (13.72x7.32x3.66)	1080 (100.43)	105	55	105	75	
MR 17	23x23x12 (7.01x7.01x3.66)	530 (49.14)	55	25	55	35	
MR 18	23x23x12 (7.01x7.01x3.66)	530 (49.14)	55	25	55	35	
Combined Rms 1-13	216x100x14 (65.85x30.49x4.27)	21600 (2006.64)	2445	1235	2445	1520	
1-2-3-9-10-11-12-13	100x141x14 (30.49x42.99x4.27)	14100 (1309.89)	1620	820	1620	1005	
3-4-7-8-9-10	100x100x14 (30.49x30.49x4.27)	10000 (929)	1180	600	1180	720	
1 & 2	67x91x14 (20.43x27.74x4.27)	6100 (566.69)	690	345	690	435	
3 & 4	67x100x14 (20.43x30.49x4.27)	6700 (622.43)	800	400	800	480	
7 & 8	33x50x14 (10.06x15.24x4.27)	1650 (153.29)	190	100	190	120	
9 & 10	33x50x14 (10.06x15.24x4.27)	1650 (153.29)	190	100	190	120	
11 & 12	33x50x14 (10.06x15.24x4.27)	1650 (153.29)	190	100	190	120	
VIP Salon	46x28x12 (14x8.54x3.66)	1288 (119.56)	Reception only (125 maximum)				
Executive Conference Centre	41x20x10 (12.5x6.10x3.05)	820 (76.25)	Board Room: 12 Maximum Reception: 24 Maximum video teleconferencing, meetings, private dinners & receptions				

PLAN on US! Get the complete Meeting Planners interactive connection through our internet site: www.wcc.mb.ca

ROOM PLANNING NOTE: Room accommodations show optimum numbers and may change according to type of staging, podiums, A/V equipment and displays used.

SECOND FLOOR PLAN

375 YORK AVENUE, WINNIPEG, MANITOBA, CANADA R3C 3J3
 PHONE: (204) 956-1720 FAX: (204) 943-0310
 TOLLFREE: 1-800-565-7776 EMAIL: info@wcc.mb.ca
www.wcc.mb.ca

■ indicates load-bearing pillar
 - - - - - indicates movable wall panels

NOTE:
Fire Exits must not be blocked at any time.

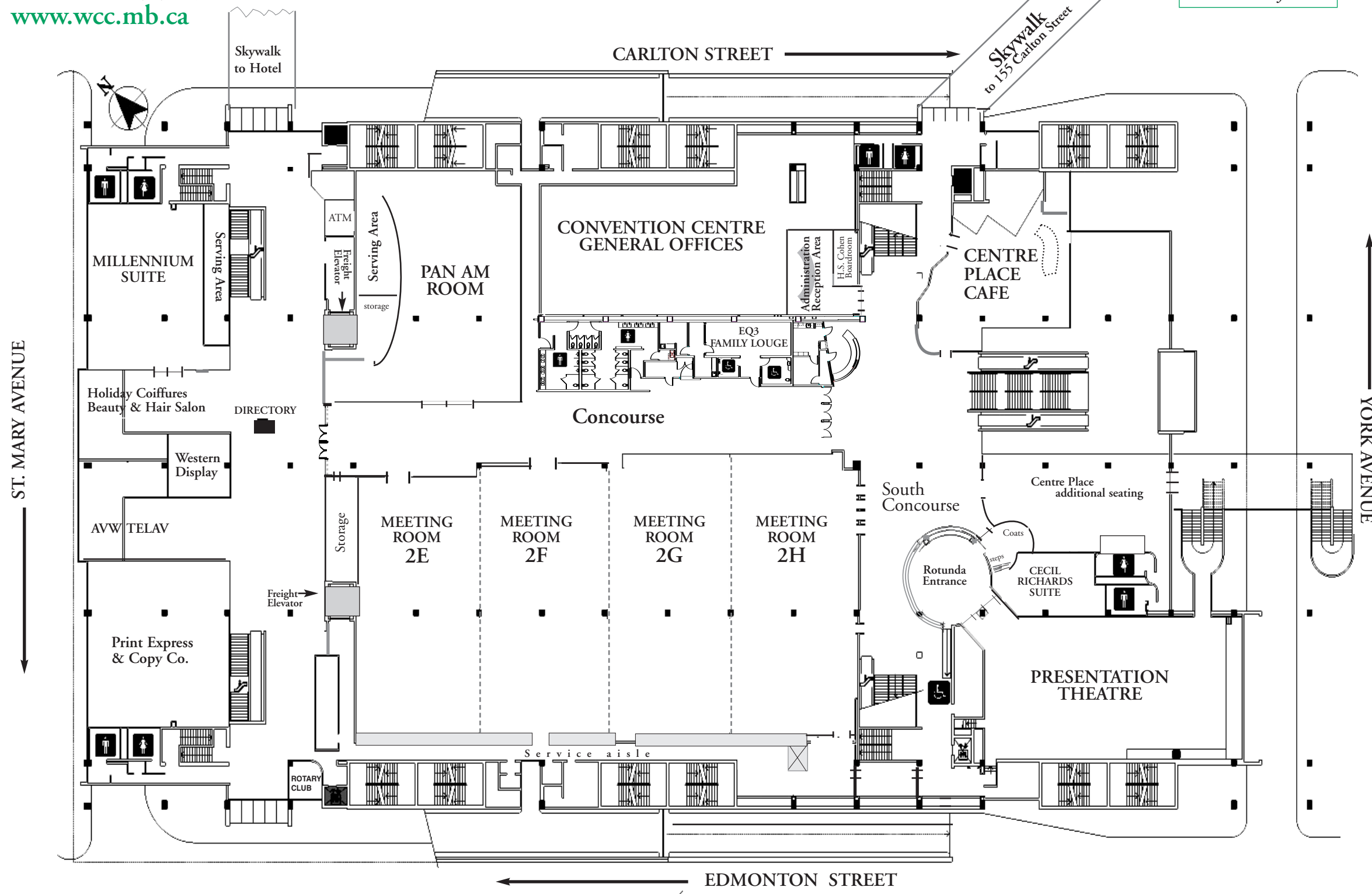

ROOM	ft ²	M ²	Theatre (number of persons/room shown)	Classroom	Banquet
------	-----------------	----------------	---	-----------	---------

Room 2E	4,552	423	440	200	300
Room 2F	4,792	446	470	210	330
Room 2G	5,017	466	480	220	340
Room 2H	4,880	454	470	210	330

Combined 2E-2F-2G-2H					
	19,241	1,790	2,100	1,100	1,300
<i>ceiling height for above rooms is 12.5 ft.</i>					

Presentation Theatre					
	5,100	474	n/a	300	n/a
<i>ceiling height varies (floor is tiered)</i>					
Fully equipped with stage, movie theatre screen, tiered comfort seating, privacy desks & control room.					
Laptop connections at all seats with high speed internet.					

Millennium Suite					
	2,650	247	270	110	150
<i>ceiling height 9 ft.</i>					

Pan Am Room					
	4,150	386	500	225	270
<i>ceiling height 8 - 10 ft.</i>					

Cecil Richards Suite					
Boardroom set-up for up to 18 people at the table, full audio/visual connections, private washrooms and coat check/registration area					

ROOM PLANNING NOTE:
 Room accommodations show optimum numbers and may change according to type of staging, podiums, A/V equipment and displays used. Sizes shown on this plan are approximate and may vary.

PLAN ON US!
 Get the complete Meeting Planners interactive connection (MeetingMatrix) through our internet site
www.wcc.mb.ca